



Installation Guide For:

ROD RAILING FOR WOOD

Call 1-800-335-5909 for Installation Support
M - F 7:30 a.m. - 6:00 p.m. CST

**This Packet MUST Accompany
Materials To Job Site**

Read all instructions before beginning installation



Horizontal Baluster / Rod Railing Installation Instructions for Wood



Level Horizontal Baluster / Rod Railing

Pages 2 - 5

Stair Horizontal Baluster / Rod Railing

Pages 6 - 12

Level - Horizontal Baluster / Rod Railing Installation Instructions FOR WOOD

Level Horizontal Baluster Railing Installation Guide

- **Please read all instructions completely before starting any installation of Horizontal Baluster / Rod Railing Systems.**
- **SAFETY:** Always be safe and follow all instructions when using power tools and always wear eye protection!
- Proper blocking must be in place before mounting posts.
- Rods come in 6ft & 8ft lengths. (Actual rail lengths are 72" and 96" respectively).
- Railings should be installed using good building principles in accordance with local building codes and the installation guidelines. Consult your local building code official and check all code requirements before installing railings. ADI™ shall not be held liable for improper or unsafe installations.
- It is the responsibility of the installer to obtain all required building permits and meet code requirements.
- For questions contact Absolute Distribution Inc. at 800-335-5909 or www.AbsoluteDist.com

Recommended Tools for Installation

- Level
- Speed Square
- Cordless Drill / Impact driver
- Quick Clamp
- Pencil
- Tape Measure
- Miter saw with high tooth count carbide blade
- #2 Square Drive Bit
- Adjustable Wrench
- 1/8" Drill Bit

Rail & Hardware Components

Horizontal Baluster Infill Assembly

Kit Includes:

- A. 8 - 5/8" Diameter Horizontal Balusters
 - B. 16 - Level Horizontal Baluster Connectors w/ Fasteners
 - C. 1 - Mid-Rail Support
 - D. 2 - Mid-Rail Support Connector Shoes w/ Fasteners
- (All hardware is included to complete rail kit assembly)*

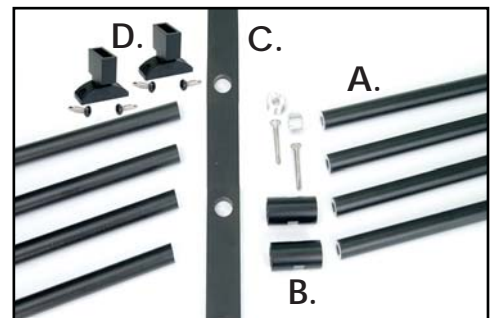

Level Mid-Rail Support



Level Baluster
Connectors



Mid-Rail Support
Shoes

5/8" Diameter Baluster (72" & 96" Length Options)

All fasteners for attaching connectors to posts and rails are included. Screws are color matched to the rail.

Level - Horizontal Baluster / Rod Railing Installation Instructions FOR WOOD

Level Rail Installation (Continued)

Step 1: Layout - Rail Framework

Lay out post placement.

If stairs are involved, it may be beneficial to start with post placement at top of stair run.

Install posts at desired locations no further apart than 72" for 6' kits and 96" for 8' kits.

Locate and install your top railing at desired height. Minimum 36" for residential applications.

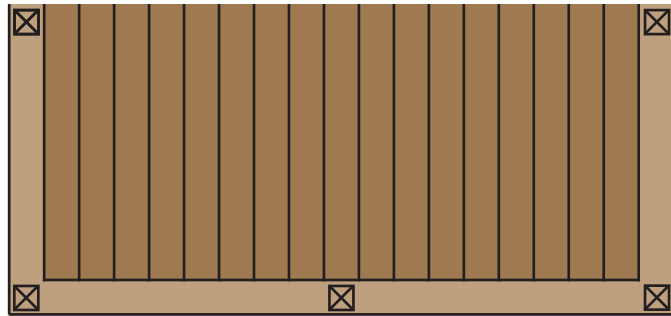

Actual Railing Lengths:

- 72" for 6' rail
- 96" for 8' rail

Step 2: Measure Railing Opening

- With your railing framework set, you can begin Rod Installation
- Measure from underside of top rail to deck surface.
- Deduct 1 3/4" from that measurement as allowance for mid-rail support connector shoes

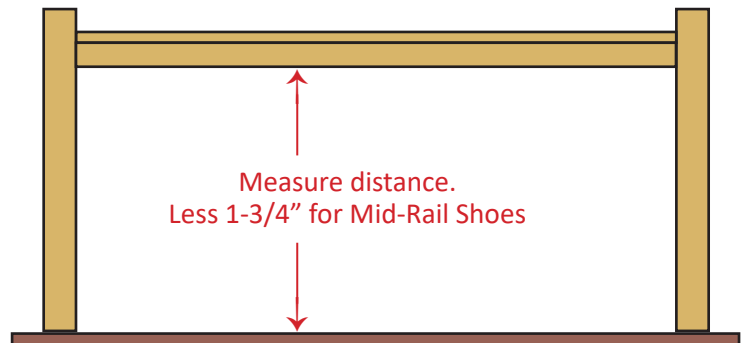

Step 3: Cut Mid-Rail Support to Fit Railing Opening

- Using the measurement taken in step 2, space out evenly on your mid-rail support leaving the same distance from edge of first and last holes to ensure equal gap at top and bottom of rods to railing and decking surface.



Step 4: Attach Mid-Rail Support

- Install mid-rail support into top and bottom connector shoes and secure with set screws.
- Move mid-rail support into position at midspan of railing and secure to top rail and deck using provided #2 square drive self-drilling screws.



Level - Horizontal Baluster / Rod Railing Installation Instructions FOR WOOD

Level Rail Installation (Continued)

Step 5: Measure to First Hole of Mid-Rail Support

- Measure from deck surface up to center of first hole on mid-rail support, use this measurement "X" to determine your first rod location from deck surface on each post.

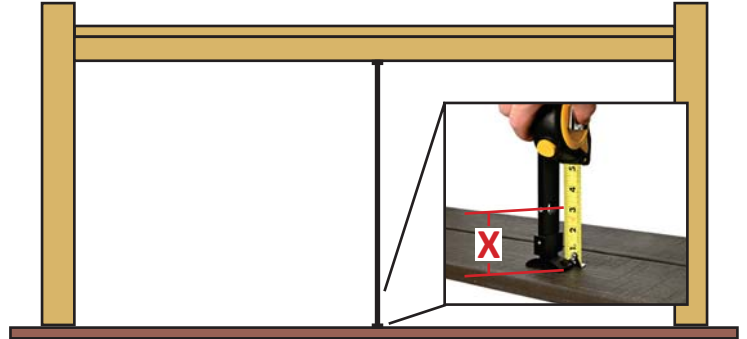

Step 6: Locate and Attached Threaded Connectors

- Measure up from the bottom of the post "X" length as determined in **Step 5**.
- From that first mark, measure up in increments of exactly $4\frac{5}{32}$ " and mark for the correct number of rods for your project. (7-8 rods typical for residential rail height).
- Pre-drill with a $\frac{1}{8}$ " drill bit.
- Install threaded connectors using provided #2 square drive self-drilling screws.

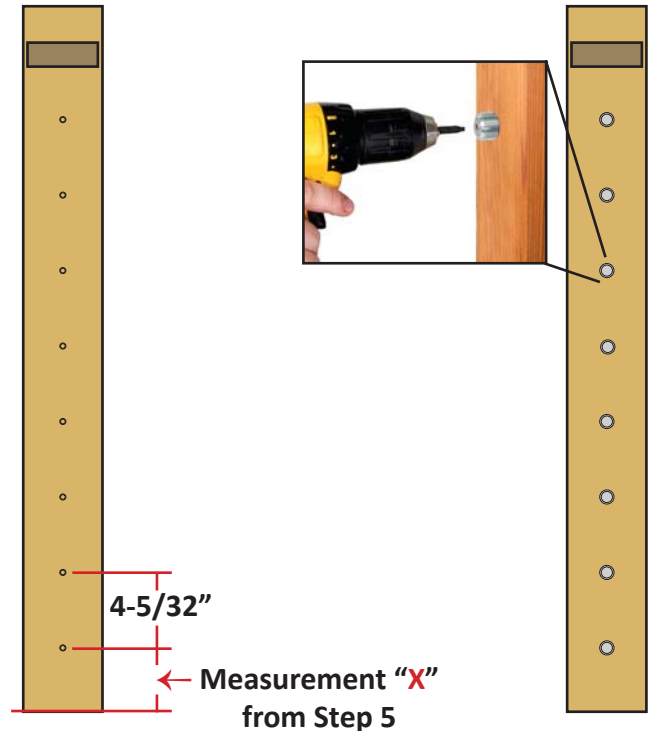

Step 7: Cut Balusters to Size

- Measure distance from inside of post to inside of post and deduct $1\frac{1}{4}$ " from that measurement. ($1\frac{1}{4}$ " deduction accounts for threaded connector thickness, $\frac{5}{8}$ " on each side)
- Cut balusters with a high tooth count carbide blade. **All cut ends must be painted to prevent oxidation.**

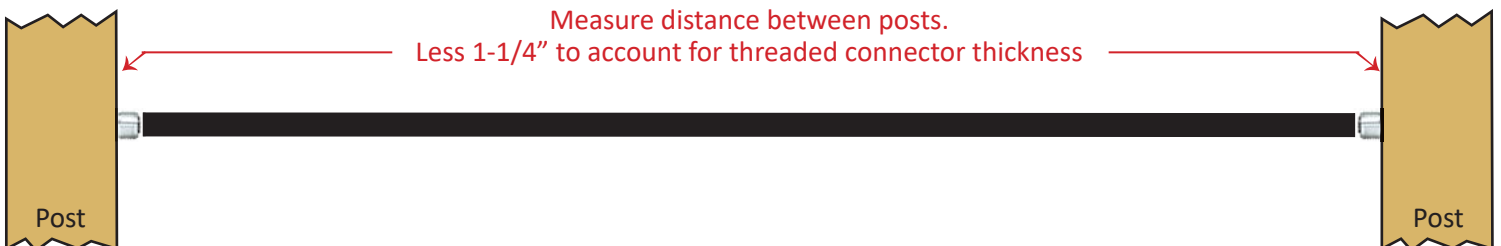

Level - Horizontal Baluster / Rod Railing Installation Instructions FOR WOOD

Level Rail Installation (Continued)

Step 8: Connect Balusters to Posts

- Insert balusters through the mid-rail support.
- Slide the connector sleeve onto each end of the baluster.
- When baluster is in place, screw the connector sleeve onto the threaded connector.
- Use the included tool or adjustable wrench to secure the connector sleeves onto the threaded connector.
- Once the connectors are properly secured, use the 3/32" allen wrench to tighten set screw.



Tighten connector sleeve onto threaded connector



Tighten set screw (Set screw shown on side for clarity)

Step 9: Finishing Touches

- Tighten any remaining set screws.
 - 3/32" allen for connector set screws.
 - 2.5 mm allen for mid-rail support set screws.
- Install post cap and 2 pc. skirt, if applicable.



Stair - Horizontal Baluster / Rod Railing Installation Instructions FOR WOOD

Stair Horizontal Baluster Railing Installation Guide

- Please read all instructions completely before starting any installation of Horizontal Baluster / Rod Railing Systems.
- **SAFETY:** Always be safe and follow all instructions when using power tools and always wear eye protection!
- Proper blocking must be in place before mounting posts.
- Rods come in 6ft & 8ft lengths. (Actual rail lengths are 72" and 96" respectively).
- Railings should be installed using good building principles in accordance with local building codes and the installation guidelines. Consult your local building code official and check all code requirements before installing railings. ADI™ shall not be held liable for improper or unsafe installations.
- It is the responsibility of the installer to obtain all required building permits and meet code requirements.
- For questions contact Absolute Distribution Inc. at 800-335-5909 or www.AbsoluteDist.com

Recommended Tools for Installation

- Level
- Speed Square
- Cordless Drill / Impact driver
- Quick Clamp
- Pencil
- Tape Measure
- Miter saw with high tooth count carbide blade
- #2 Square Drive Bit
- Adjustable Wrench
- 1/8" Drill Bit

Rail & Hardware Components

Horizontal Baluster Infill Assembly

Kit Includes:

- A. 8 - 5/8" Diameter Horizontal Balusters
 - B. 16 - Stair Horizontal Baluster Connectors w/ Fasteners
 - C. 1 - Stair Mid-Rail Support
 - D. 2 - Mid-Rail Support Connector Shoes w/ Fasteners
- (All hardware is included to complete rail kit assembly)*

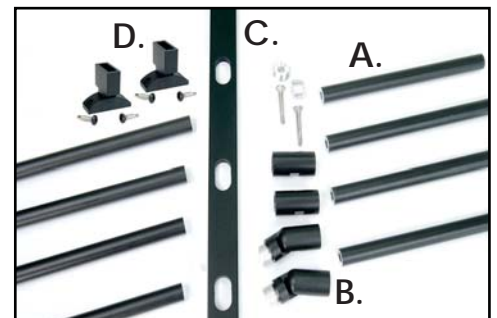

All fasteners for attaching connectors to posts and rails are included. Screws are color matched to the rail.

Stair - Horizontal Baluster / Rod Railing Installation Instructions FOR WOOD

Post Placement & Installation

Step 1: Layout

Lay out post placement.
Stair rail installation must start with post placement at top of stair run.

Install posts at desired locations no further apart than 72" for 6' kits and 96" for 8' kits.

Actual Rod Lengths:

- 72" for 6' rail
- 96" for 8' rail

Step 2: Mount Posts

- Start with top post (■). Set into place and fasten post
- Check that post is plumb and shim if necessary
- After top posts (■) are installed, temporarily place lower post(s) (☒) on tread to allow for adjustment to ensure proper spacing between the posts.
- Once rails are set all posts can be permanently mounted.

Start Here
Top of Stairs

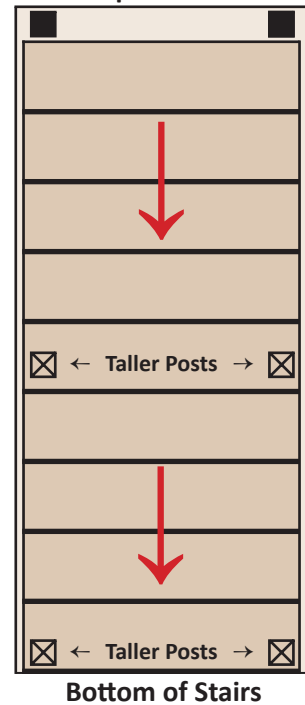

Step 2: Reference Diagram

Step 3: Determine Bottom Rod Location

- Determine the location of the bottom rod to ensure clearance of stair tread and that it meets 6" sphere code requirement for stairs.
- Clamps can be used to temporarily hold rod in place.

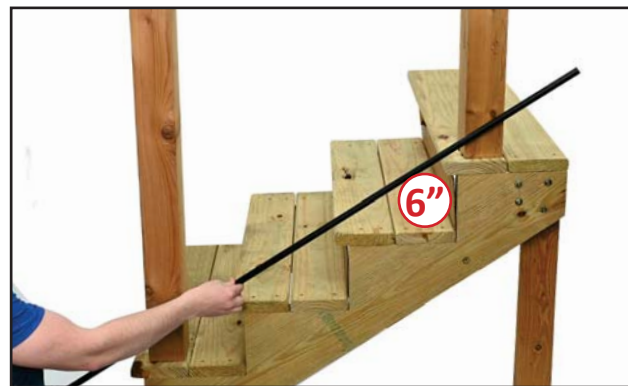

Step 4: Locate top stair connector

- With bottom rod clamped in place. Align the top post stair connector next to the rod at the same angle as the rod.
- Mark the top and bottom sides of the stair connector on the post.

NOTE: *If using a **Post Skirt**, ensure the connector will have enough clearance before installing.*



Stair - Horizontal Baluster / Rod Railing Installation Instructions FOR WOOD

Stair Rail Installation

Step 5: Locate Top Post Threaded Connectors

Part A: Find the center between the marks made in Step 8. Ensure this mark (X) is centered on the post.

Part B: Measure up 4-5/32" from the mark made in Part A and mark. Continue this for the remaining threaded connectors

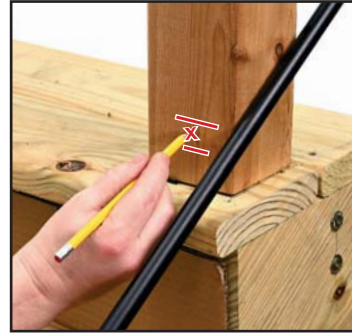

Step 6: Attach Threaded Connectors

- Attach the threaded connectors at the location of the marks made in Step 5.
- Pre-drill with a 1/8" drill bit.
- Install threaded connectors using provided #2 square drive self-drilling screws.

NOTE: If using a **Post Skirt**, ensure the connector will have enough clearance before installing.



Step 7: Install Threaded Connectors

- Continue installing all remaining threaded connectors onto post.

Note: 7 or 8 threaded connectors are commonly used for a 36" rail
8 or 9 threaded connectors are commonly used for a 42" rail

The amount of Rods used is determined by the top rail height and configuration

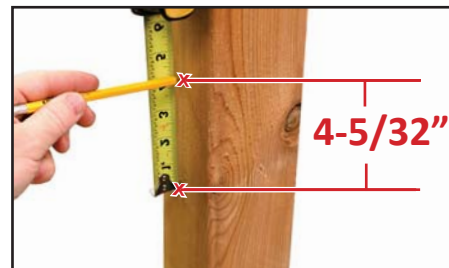

Stair - Horizontal Baluster / Rod Railing Installation Instructions FOR WOOD

Stair Rail Installation (Continued)

Step 8: Attach Stair Connector

- Attach the first stair connector to post at top of stair.
- Then, temporarily attached a full length rod into this connector using the set screw to hold rod into place.

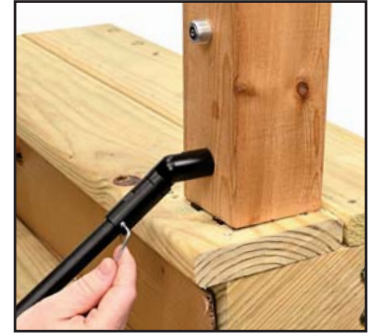

Step 9: Locate Rod Bracket Location - Lower Post

- With the rod temporarily fixed into the connector at the top post, determine the location of the bottom rod.
- Ensure spacing from bottom rod to the nose of the stairs is equal on all treads.
- Once located, clamp the bottom rod to the lower post.

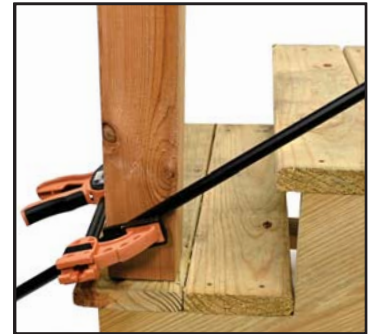

Step 10: Locate bottom stair connector

- With bottom rod clamped in place. Align the bottom stair connector next to the rod at the same angle as the rod.
- Mark the top and bottom of the stair connector on the post.

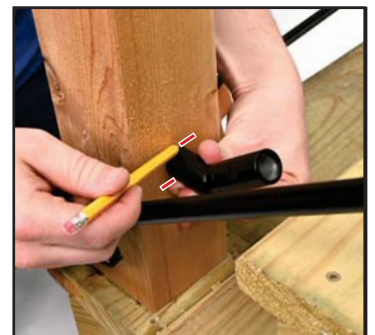

Step 11: Locate and Attach Bottom Threaded Connector

Part A: Find the center between the marks made in Step 10. Ensure this mark (X) is centered on the post.

Part B: Measure up 4-5/32" from the mark made in Part A and mark. Continue this for the remaining threaded connectors

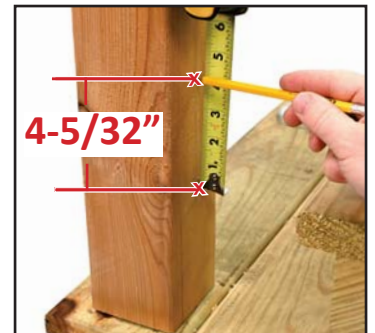

Stair - Horizontal Baluster / Rod Railing Installation Instructions FOR WOOD

Stair Rail Installation (Continued)

Step 12: Install Threaded Connectors

- Attach threaded connectors at the locations of the marks made in Step 11.
- Pre-drill with a 1/8" drill bit.
- Install threaded connectors using provided #2 square drive self-drilling screws.



Note: *This post may need to be removed to allow for the lowest threaded connector to be installed onto post.*

Step 13: Determine Length of Rods

- With the stair connectors installed on the top and bottom posts, measure the distance between the connectors.
- Use that measurement and deduct 1/4" from that length and cut your rods using a fine tooth carbide blade.

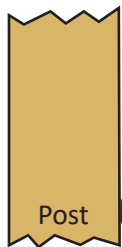

Measure distance between
Stair Connectors.
Less 1/4" to allow for
easy rod installation

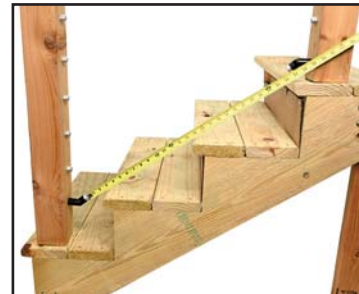

Step 14: Place Bottom Rod

Temporarily place the bottom rod into the connectors



Stair - Horizontal Baluster / Rod Railing Installation Instructions FOR WOOD

Stair Rail Installation (Continued)

Step 15: Mid-Rail Support Bottom Adjustment

- Determine the mid-point of your rail and locate the mid-rail support at that point.
- Place the mid-rail support with the excess length side **down INTO THE SHOE** and set support next to the bottom rod.
- Determine the distance from the center of the rod to the center of the allen screw in the first hole on the mid-rail support.
- Use this measurement "X" in the next step.

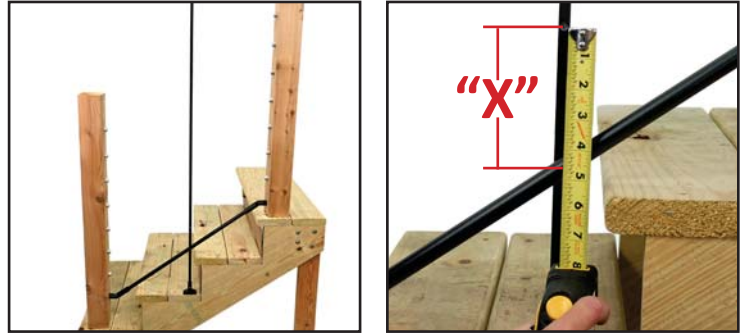

Step 16: Cut Bottom End of Mid-Rail Support

Part A:

Measure up from the bottom of the mid-rail support "X" length as determined in [Step 15](#). Mark and cut this bottom end. *Note: This will be the same for 36" or 42" rail height.*



Step 17: Mid-Rail Support Top Adjustment

- Determine top rail placement and fix into place.
- Place the mid-rail support next to the top rail (Ensure mid-rail support is plumb)
- Mark the mid-rail support where the top rail and mid-rail support intersect.
- Use this mark in the next step.

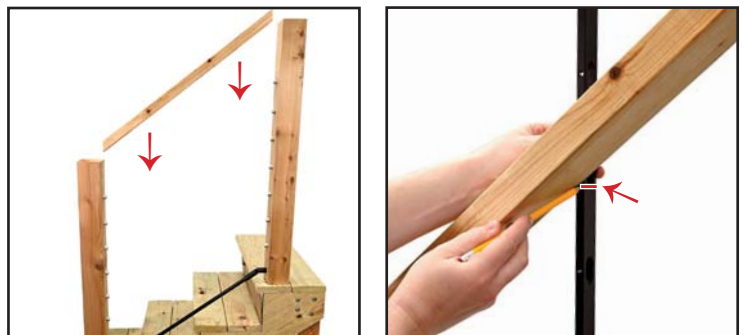

Step 18: Cut Top End of Mid-Rail Support

Part A:

Measure down 7/8" from the mark made in [Step 17](#) and cut. *Note: 7/8" measurement accounts for the mid-rail support shoe.*



Stair - Horizontal Baluster / Rod Railing Installation Instructions FOR WOOD

Stair Rail Installation (Continued)

Step 19: Install Rods and Mid-Rail Support

- Attach the stair connectors on each post.
- Pass the rods through the mid-rail support, then attach the rods to the post using the stair connectors.
- With rods fixed in place, plumb the mid-rail support and fasten the bottom support shoe into place using the provided #2 square drive self-drilling screws.



Step 20: Mount Support Shoe to Top Rail

- Align the Support Shoe with the top rail and fasten to top rail using the provided #2 square drive self-drilling screws.
- Pre-drill holes if desired

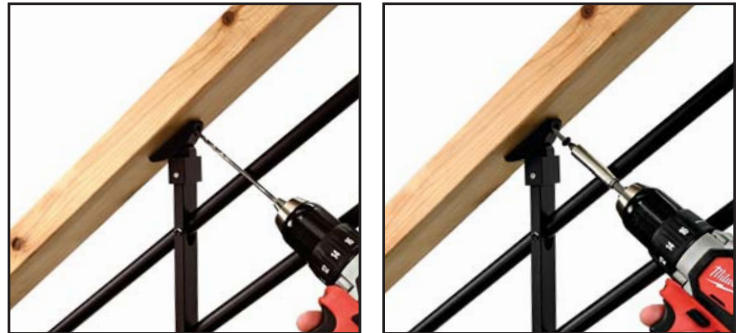

Step 21: Finishing Touches

- Fasten all remaining screws and set screws.
2.5 mm allen wrench for mid-rail support
3/32 allen wrench (included) for rod connectors
- Install post cap and 2 pc. skirt, if applicable.





Stair - Horizontal Baluster / Rod Railing Installation Instructions FOR WOOD

Stair Rail Installation (Continued)

Marketed and Distributed by:

